



Johnny Street
Ofc. Ph. (806) 293-9944
Cell Ph. (806) 847-7400
Fax (806) 288-0146

johnny@streetsrealestate.com

Floyd County TX* Allmon Community Property* Excellent Location* Several Barns* Tract 15

Legal Description: 8 acres, more or less, Abstract A938, Survey 1, Henry Switzer (Allmon), Floyd County Texas.

Location: Southwest quadrant of Floyd County Texas with FM 54 being the north boundary and FM 378 on the east boundary.

Description: This is a really nice property with approximately 8 acres and several barns. If you are looking for storage barns, this might be the property for you. Excellent access is available with FM 54 and FM 378 frontage. There are 5 barns on the property. Two big nice barns are approximately 200' x 70' and 200' x 65'. These barns could be used for several different storage uses. The other barns are 60' x 80', 100' x 30', and 30' x 60'. The Seller may have some equipment and other items that will be excluded from the sale and may need some time to remove these items and equipment. View maps and pictures on my website at www.street.land
Contact Johnny Street at 806-847-7400.

Price: \$225,000.00

Hale KDR Feeders, Inc Tract
15

Allmon
Property
Tract 15



Created 8/15/2024 using Map My Property
in TexasForestInfo.com

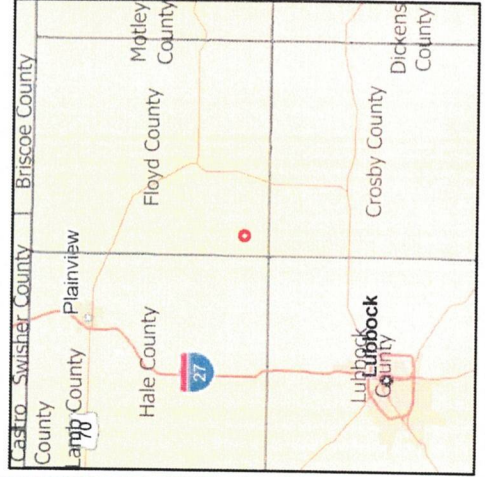

Powered by ESRI. Basemaps provided by ArcGIS Online.

KDR Feeders
Allmon Property
Tract 15

[Home](#) [Return to Search](#)  [Print](#)

Property Year 2024 [Tax Summary](#) [Map/GIS](#)

Information Updated 8/14/2024

Property ID: R000005976 Geo ID: 20938.020.0001.0

< [Previous Property](#) 3 / 4 [Next Property](#) >

Property Details

Ownership

KDR FEEDERS INC
2784 FM 54
PETERSBURG, TX 79250
Ownership Interest: 1.0000000
M-24

Available Actions

[CLICK HERE FOR PDF APPRAISAL NOTICE](#)

Qualified Exemptions

Not Applicable

Legal Information

Legal: Acres: 8.000, Abst: A938, SURV: 1 HENRY SWITZER (ALLMON)
Situs: FM 378 3410

Property Valuation History

Values by Year		2024	2023	2022	2021	2020	n/a
Improvements	+	\$23,530	\$23,530	\$23,530	\$23,530	\$23,530	\$0
Land	+	\$6,800	\$6,800	\$6,800	\$6,800	\$6,800	\$0
Production Market	+	\$0	\$0	\$0	\$0	\$0	\$0
Personal	+	\$0	\$0	\$0	\$0	\$0	\$0
Mineral	+	\$0	\$0	\$0	\$0	\$0	\$0
Total Market	=	\$30,330	\$30,330	\$30,330	\$30,330	\$30,330	\$0
Agricultural Loss	-	\$0	\$0	\$0	\$0	\$0	\$0
Homestead / Circuit Breaker Cap Loss	-	\$0	\$0	\$0	\$0	\$0	\$0
Total Assessed	=	\$30,330	\$30,330	\$30,330	\$30,330	\$30,330	\$0

Improvement / Buildings Improvement Value: \$23,530

Group Sequence	Code	Building Description	Year Built	Square Footage	Perimeter Footage
1	BN	BARN		1,800	180
7	DR	DRYER		400	80
8	SD	SHED		288	68
9	STG4	STORAGE EXC		600	100
10	STG4	STORAGE EXC		600	100
11	STG4	STORAGE EXC		5,456	300
1	BU	BUSINESS		2,949	278
2	SD	SHED		540	96
1	BN	BARN		195,333	520
2	BN	BARN		349,333	560
3	TA	TANK		66,664	
4	TA	TANK		9,999	

Land Details Market Value: \$6,800 Production Market Value: \$0 Production Value: \$0

Land Code	Acres	Sq. Ft.	Front Ft.	Rear Ft.	Depth	Mkt. Value	Prd. Value
101	8.000	348,480	0	0		6,800	0

Deed History

Conveyance	Volume	Page	Deed Date	Instrument
ALLMON STORAGE	102	691	6/23/2015	000707
n/a	0239	0877	11/1/1986	
n/a	00239	00874	1/1/1986	
n/a	00000	00000	1/1/1954	

Property Tax Estimation by Entity / Jurisdiction

Code	Description	Taxable Value	Tax Rate per \$100	Tax Factor applied to Taxable Value	Estimated Tax
CHD	CAPROCK HOSPITAL DST	30,330	\$0.11827	0.0011827	\$35.87
FLO	FLOYD COUNTY	30,330	\$0.685	0.00685	\$207.76
HPW	HIGH PLAINS WATER	30,330	\$0.0042	0.000042	\$1.27
SPE	PETERSBURG ISD	30,330	\$1.3263	0.013263	\$402.27
Total Estimation			\$2.13377	0.0213377	\$647.17

The above property tax estimation is not a tax bill. Do not pay.
[Click here to view actual Property Tax Bill.](#)

Southwest Data Solutions provides this information "as is" without warranty of any kind.
 Southwest Data Solutions is not responsible for any errors or omissions.